

(20e)

## List of Approval Conditions

### Application No. A/I-MWI/28

Application Site : Ma Wan Lot No. 392, Ma Wan Island

Subject of Application : Minor Amendments to Approved Scheme (Application No. A/I-MWI/26) for addition of Day Nursery/Child Care Centre in the Kindergarten

Date of Approval : 9.5.2003

Approval Conditions : (a) the design and provision of the proposed child care centre to the satisfaction of the Director of Social Welfare or of the Town Planning Board;

(b) the design and provision of fire service installations to the satisfaction of the Director of Fire Services or of the Town Planning Board; and

(c) the permission shall cease to have effect on 9.5.2007 unless prior to the said date either the development hereby permitted is commenced or this permission is renewed.



THE MLP WILL BE SUBJECT TO CHANGE TO  
INCORPORATE THE REQUIREMENTS OF  
THE APPROVAL CONDITIONS



LEGEND

- MASTER LAYOUT PLAN BOUNDARY
- EMERGENCY VEHICULAR ACCESS
- 1. RESIDENTIAL BLOCK NUMBER
- 11. NUMBER OF DOMESTIC STOREYS
- 1. TUNG WAN PIER & ANCILLARY FACILITIES FOR MAWAN TRANSPORTATION SERVICES, e.g. RESTROOM, OFFICE & WORKSHOP.
- 2. PAK WAN SERVICE AREA.
- 3. CENTRAL OPEN SPACE.
- 4. LOW RISE RESIDENTIAL BLOCKS.
- 5. CENTRAL CLUB HOUSE.
- 6. TUNG WAN BEACH CLUB HOUSE.
- 7. BEACH COMMERCIAL COMPLEX.
- 8. RETAIL SHOPS.
- 9. BUS LAY-BYS AND BUS TERMINUS UNDER RESIDENTIAL BLOCKS.
- 10. Kindergarten / Child Care Centre / Day Nursery
- 11. SITE RESERVED FOR A PRIMARY SCHOOL.
- 12. TOLL PLAZA FACILITY.
- 13. RELOCATED TIN HAU TEMPLE.

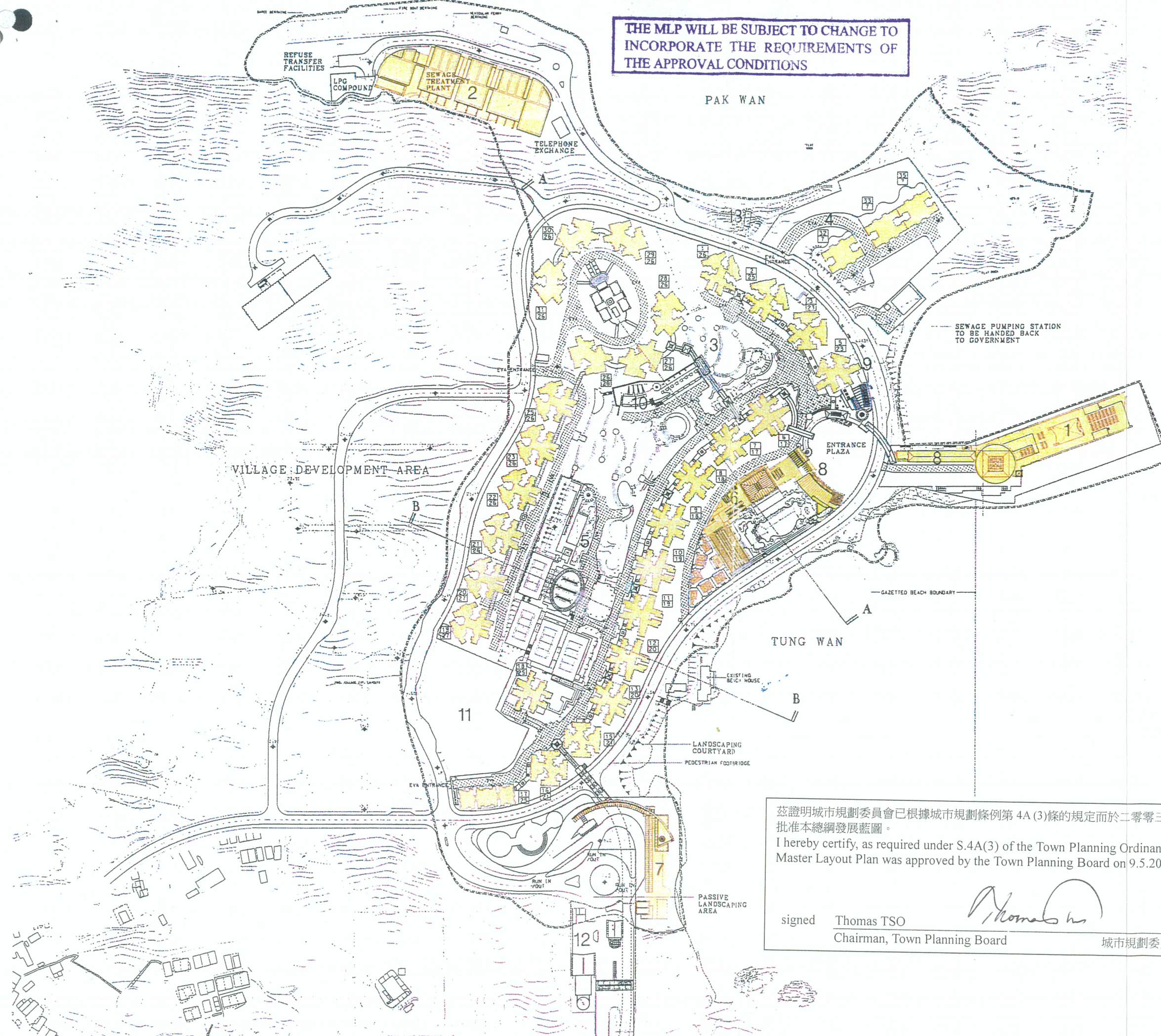

茲證明城市規劃委員會已根據城市規劃條例第 4A (3) 條的規定而於二零零三年五月九日批准本總綱發展藍圖。  
I hereby certify, as required under S.4A(3) of the Town Planning Ordinance, that this Master Layout Plan was approved by the Town Planning Board on 9.5.2003.

signed Thomas TSO  
Chairman, Town Planning Board

*Thomas TSO*

曹萬泰  
城市規劃委員會主席 簽署

MASTER LAYOUT PLAN

SCALE  
1 : 3000



FIGURE NO.

Date: 10 April 2003

MA WAN ISLAND